



# OPEN HOUSE

## JAN 15th 4-6PM

### MAIN PRESENTATIONS

#### **C** HIGH SCHOOL AP REQUIREMENTS

4:10-4:30 PM

CAFETERIA

-Dr. Andrew Thomson

#### **C** JUNIOR HIGH AEP REQUIREMENTS

4:30-4:50 PM

CAFETERIA

-Dr. Andrew Thomson

#### **D** VIMY DANCE PERFORMANCE

5:00 - 5:20 PM

3RD FLOOR DANCE STUDIO

#### **M** PRINCIPAL'S MESSAGE

5:30-5:50 PM

MAIN GYM

-Principal Jillian Marino

## SCHEDULE

### SPORTS ALTERNATIVE PROGRAMMING

#### **O** GREEN & GOLD SOCCER

4:00-6:00 PM

ORTONA HALL

#### **D** VIMY DANCE

4:00-6:00 PM

3RD FLOOR DANCE

#### **E** VIMY ELITE

4:00-6:00 PM

STUDENT SERVICES

#### **O** OKANAGAN HOCKEY ACADEMY

4:00-6:00 PM

ORTONA HALL

#### **M** AAD PROGRAM INFORMATION

4:00-6:00 PM

MAIN GYM

Brazilian Jiu-Jitsu

Esports

Golf

Hockey

Lacrosse

Ringette

Softball

Sport Fit

#### **O** ORTONA HALL

Baseball

Outdoor Pursuits

### CORE SUBJECTS

4:00-6:00 PM

English → East Hallway

Math → West Hallway

Science → Central Hallway

Social Studies → East Hallway

### OPTION CLASSES

4:00-6:00 PM

Art → 2nd Floor Centre Hallway

Construction → Construction Lab 144

Food Studies → Foods Room 246

Photo, Sports Media & Broadcasting → Room 208

Second Languages → 2nd Floor Centre Hallway

### OTHER PROGRAMS

4:00-6:00 PM

Career Pathways EPSB → Student Headquarters

Counseling → Student Services

Fitness Centre → South Gym Hallway

ISP → Room 112

Learn Write/ Correspondence → Room 210

Parent Council → Student Headquarters

Ski Trip → Student Headquarters

Spin Studio → South Gym Hallway

Sports Physiotherapy → Main Hallway

Student Leadership → 2nd Floor East Hallway

Travel Club → Student Headquarters

[vimyridge.epsb.ca](http://vimyridge.epsb.ca)

SEE REVERSE SIDE MAP FOR EVENT LOCATIONS

@vimyacademy

BASEBALL-SOFTBALL | BRAZILIAN JIU-JITSU | DANCE | ELITE ATHLETE | ESPORTS | GOLF | HOCKEY  
LACROSSE | OKANAGAN HOCKEY | OUTDOOR PURSUITS | RINGETTE | SOCCER | SPORTFIT

TURNING PASSION INTO PERFORMANCE → **#VIMYPROUD**

# 1<sup>ST</sup> FLOOR

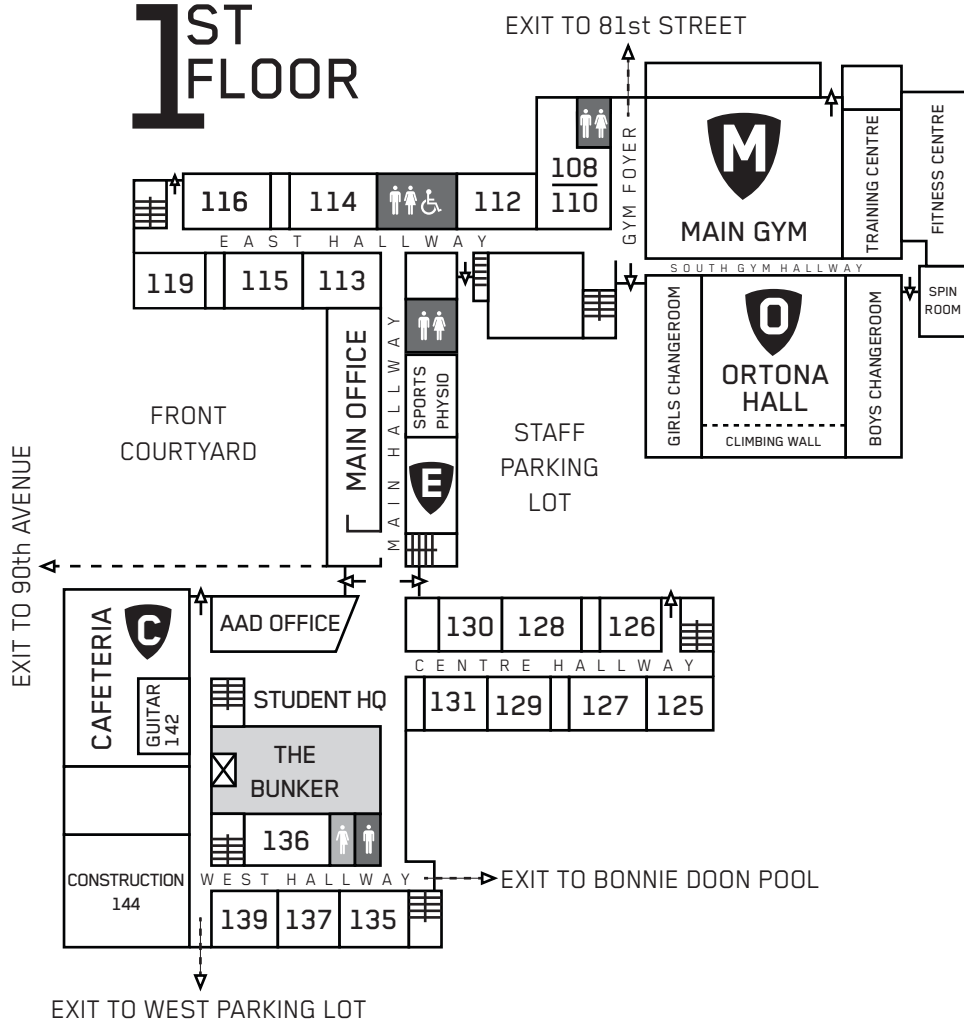

# 2<sup>ND</sup> FLOOR



# 3<sup>RD</sup> FLOOR

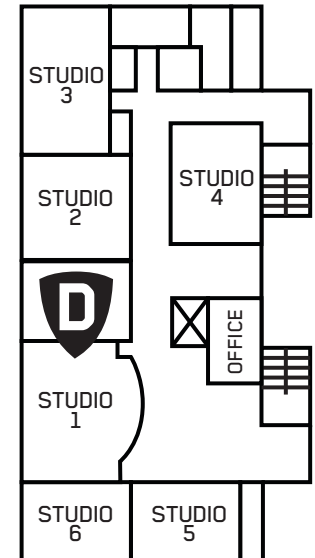

## LEGEND

- |  |                     |  |                                      |
|--|---------------------|--|--------------------------------------|
|  | WASHROOMS           |  | CAFETERIA (AEP/AP PRESENTATION)      |
|  | INCLUSIVE WASHROOMS |  | DANCE STUDIO (3 <sup>RD</sup> FLOOR) |
|  | ELEVATOR            |  | STUDENT SERVICES                     |
|  | STAIRWELL           |  | MAIN GYM                             |
|  | EXIT/ENTRANCE       |  | ORTONA HALL                          |

